

# lucid™

# DA9624 24-BIT STEREO D/A CONVERTER

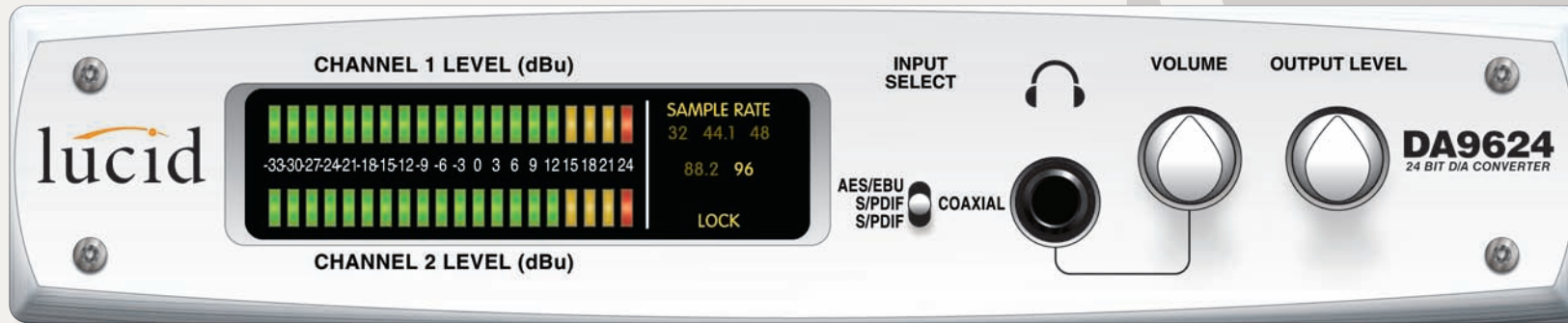

[Pictured actual size]

## DA9624: Stereo 24-bit precision D/A conversion at sample rates up to 96 kHz.

"The best part about this converter pair (AD9624 and DA9624) is how they sound. The conversion is first rate, with attention to detail not only in the digital domain, but also in the analog circuitry."

— George Petersen, *Mix Magazine*

### World-class D/A conversion for recording, mastering, and post-production.

This converter bridges the gap between analog and digital domains with transparent audio conversion. True 24-bit resolution is the best way to record and process all the detail the human ear can hear. The DA9624 supports sample rates of 96 kHz, 88.2 kHz, 48 kHz, 44.1 kHz, and 32 kHz. An easy-to-read 20-segment LED ladder on shows you exactly where to set I/O controls for optimal D/A conversion. A user-selectable noise shaping function

enhances the clarity of low-level material for superior imaging and realism when creating 16-bit masters.

### Multiple connections for flexible operation.

The DA9624 receives input through through professional AES/EBU and consumer S/PDIF (coaxial and optical TOSLINK) connectors and it delivers analog output through XLR and 1/4" connectors for interfacing with balanced or unbalanced equipment. A front panel headphone output makes it easy to monitor audio levels.

### A perfect pair.

Rack the DA9624 next to the AD9624 A/D Converter using a Lucid RM-4 rack mount tray, or use either unit on its own on its own to meet your specific interface requirements.

### DA9624 Features

- Half rack space, two (2) channel, digital to analog multi-format converter. Applications: Studio, Broadcast, Post-Production.
- Stereo 24-bit precision D/A conversion at sample rates up to 96 kHz.
- Three (3) selectable digital inputs: AES/EBU (XLR), S/PDIF (coaxial) or S/PDIF (TOSLINK).
- Separate headphone volume and front panel output controls.
- 20-segment output level LED ladders.

# Engineered by Symetrix™

6408 216th St. SW | Mountlake Terrace, WA 98043 | USA | Tel: +1 (425) 778.7728 | Fax: +1 (425) 778.7727 | Web: [www.SymetrixAudio.com](http://www.SymetrixAudio.com)

# lucid™

# DA9624 24-BIT STEREO D/A CONVERTER



[Pictured actual size]

## Specifications

### Performance Data

#### Frequency response:

For sample rates of 88.2 kHz and 96 kHz:

20 Hz to 40 kHz ( $\pm 1$  dB)

For sample rates of 44.1 kHz and 48 kHz:

20 Hz to 20 kHz ( $\pm 1$  dB)

For 32 kHz sample rate:

20 Hz to 15 kHz ( $\pm 1$  dB)

**Dynamic range:** >114 dB, A-weighted

**Analog output impedance:** 20k  $\Omega$  balanced, 10k  $\Omega$  unbalanced

**Maximum analog output level:** +25 dBu balanced

**Maximum headphone output level:** 20 V peak to peak into 2000  $\Omega$ , 160  $\Omega$  output impedance

**Analog output attenuation range:**  $\infty$  to 0 dB

### Connectors

**Digital inputs:** AES3 (XLR), S/PDIF (coaxial), and TOSLINK (optical)

**Analog outputs:** Balanced XLR, balanced/unbalanced 1/4" TRS, and front panel-mounted headphone output: stereo 1/4" TRS

**Power In:** 7-pin DIN

### Physical

**Size:** (HxWxD) 1/2 rack unit,

1.72 in. x 8.5 in. x 8 in. (4.37 cm x 21.59 cm x 20.32 cm)

**Shipping Weight:** 6.7 lbs. / 3.04 kg

### Electrical

**Power Requirements:**

115 VAC nominal, 95 to 130 VAC, 50 to 60 Hz, 10 Watts

230 VAC nominal, 207 to 253 VAC, 50 Hz, 10 Watts

### Environment

Maximum operating ambient temperature: 30° C.

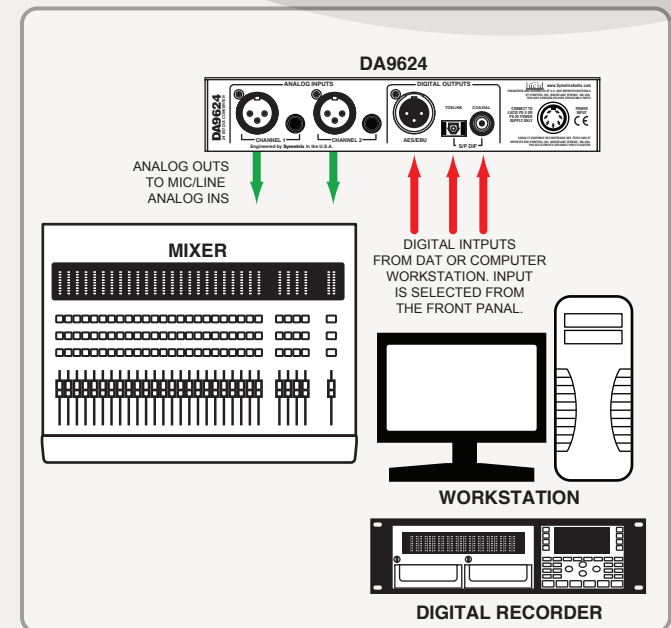

© 2007, Symetrix, Inc. All rights reserved. In the interest of continuous product improvement, features and specifications are subject to change without notice.

# Engineered by Symetrix™

6408 216th St. SW | Mountlake Terrace, WA 98043 | USA | Tel: +1 (425) 778.7728 | Fax: +1 (425) 778.7727 | Web: [www.SymetrixAudio.com](http://www.SymetrixAudio.com)